

Enroll Android Device with Intune

1



Open the Google Play Store, search for 'Company Portal' and install

2



Allow Company Portal to access your contacts?

Allow

Don't allow

Open the Company Portal app, select yes to Allow Notifications

3

Microsoft

Sign in

first.last@androsysinc.com

[Can't access your account?](#)

Back

Next

Choose Sign In, then enter your ASI email address and password

4

On the Setup page,
select Begin

5

Review the privacy policy,
then select Continue

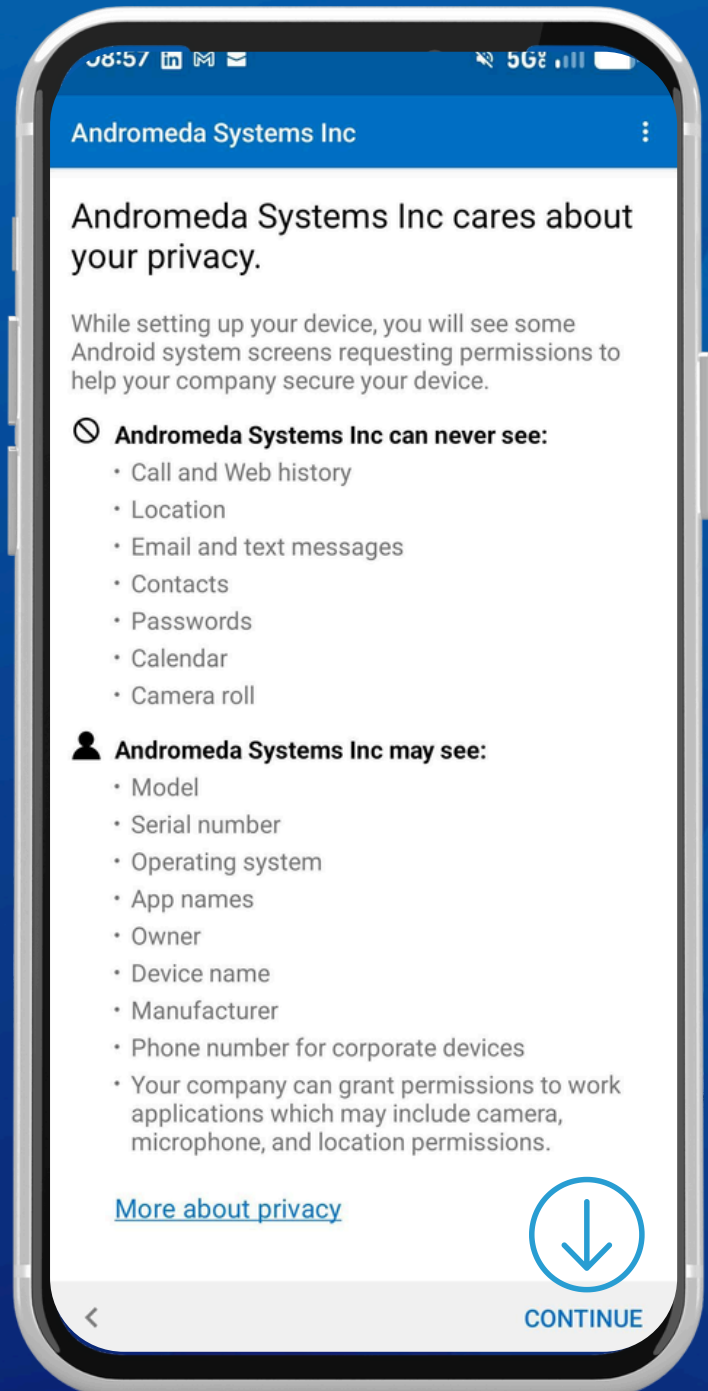
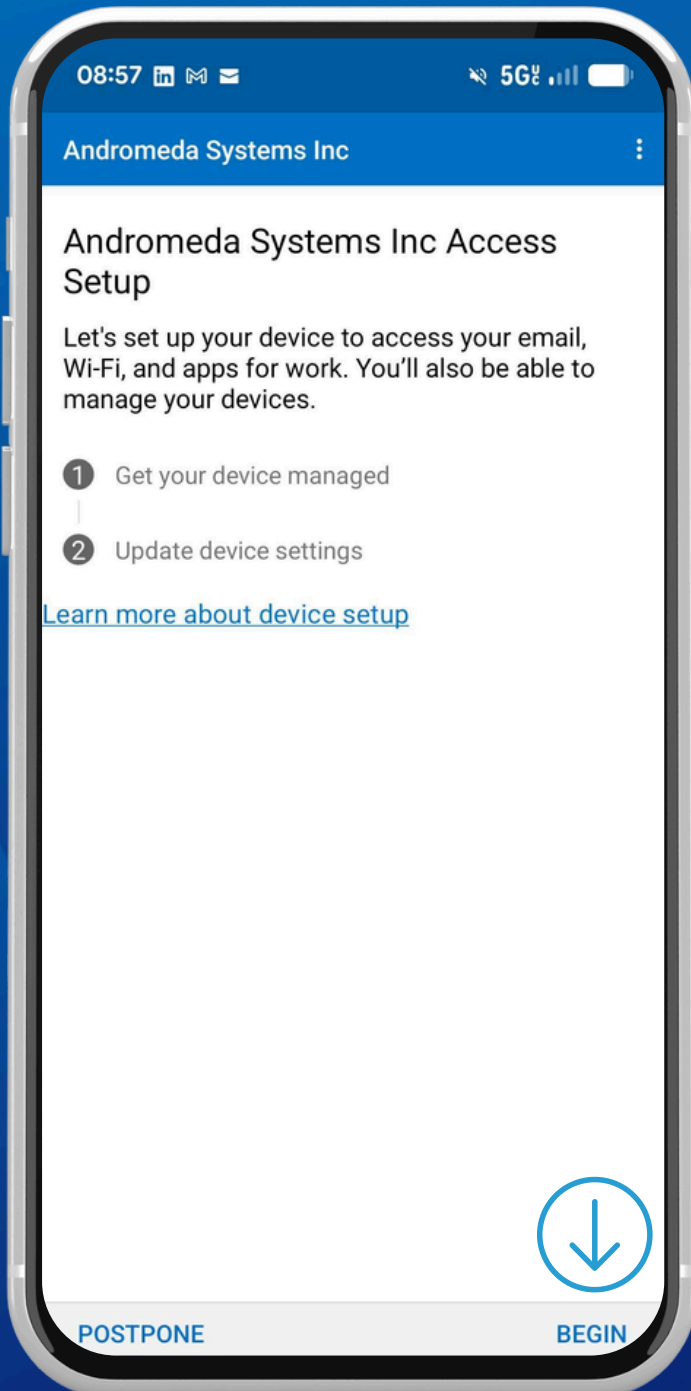

6

Your phone will setup your Work profile, then add the device to the company portal

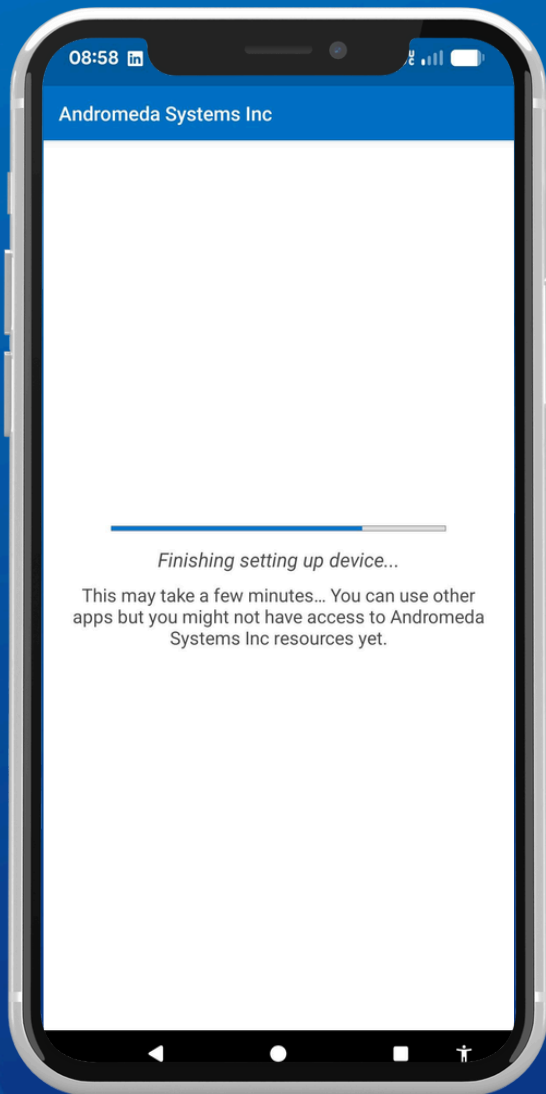

7

During this time, your phone will automatically download Company applications to add to your work profile



8

Once completed, when you go to your apps, you will see your separate Personal and Work profiles you can switch between

